



Using IFTTT you can for instance use recipes to turn on a light when you arrive at sundown using a recipe of the form IF (its sundown) THEN (turn on a light).

Users can also publish recipes that other users can download and use (and edit).

The products/services on IFTTT are called Channels, each channel will have its own Triggers and Actions. There are currently more than 300 channels available.

THE MUSAIC IFTTT CHANNEL

The Mosaic IFTTT Channel has a rich set of Triggers and Actions that allow many useful recipes to be created. At the end of this document you can find the link to our channel for full details.

Brands/Channels can also publish suggested recipes. Mosaic has published a set of suggested recipes for things you can do with Mosaic and some other products via IFTTT such as:

HOW TO CONNECT MUSAIC WITH IFTTT

To use IFTTT you need to create a Mosaic Web Account (if you have not already done so) which links your players to our web service and allows communication to the IFTTT web service.

Creating a Mosaic web account

Mosaic Web Accounts are completely free and we will never share any of the information stored with any third parties. The account connection is made via a secure encrypted method and no personal information (other than the email address used for signup) is needed or retained. Open the Mosaic App and go to the Settings menu. Under Mosaic Portal/Web Account tap 'Login'.

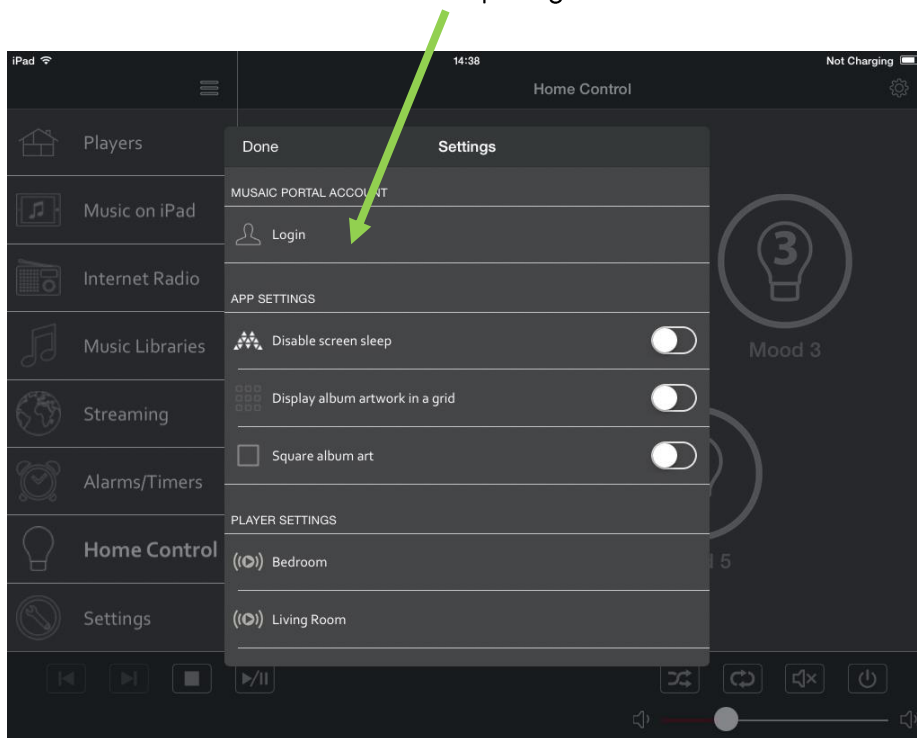

In the pop up enter your email and your chosen password and tap the blue 'Sign Up' button.

Your email address will be used as your username.

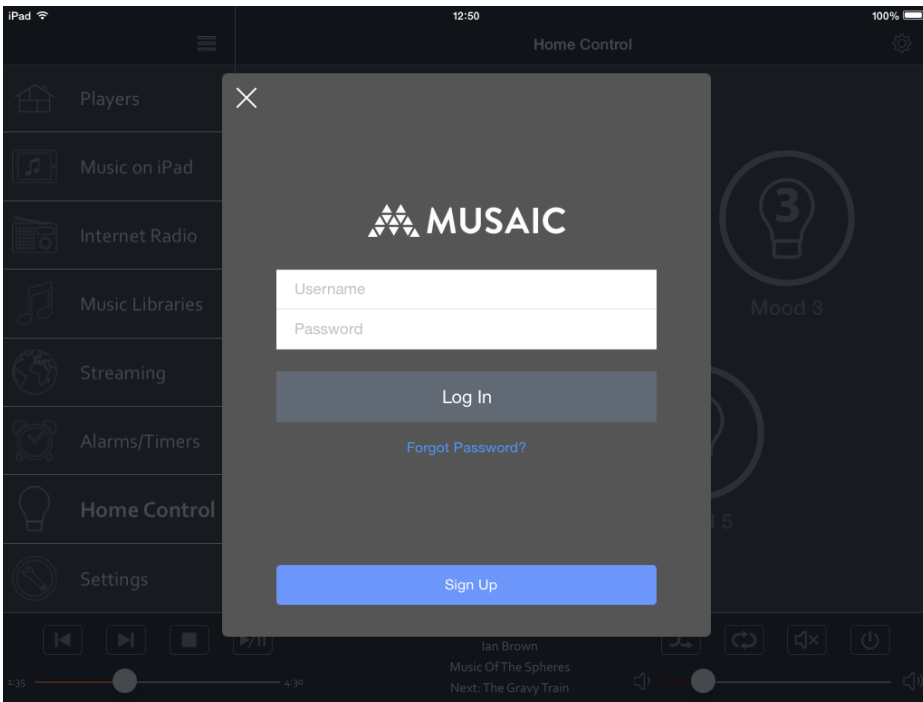

Now login to your account by again pressing the Login button under Musaic Portal Account.

Finally, now that you have an account, you need to link each of your Musaic Players to it. Under Player Settings select a unit to add:

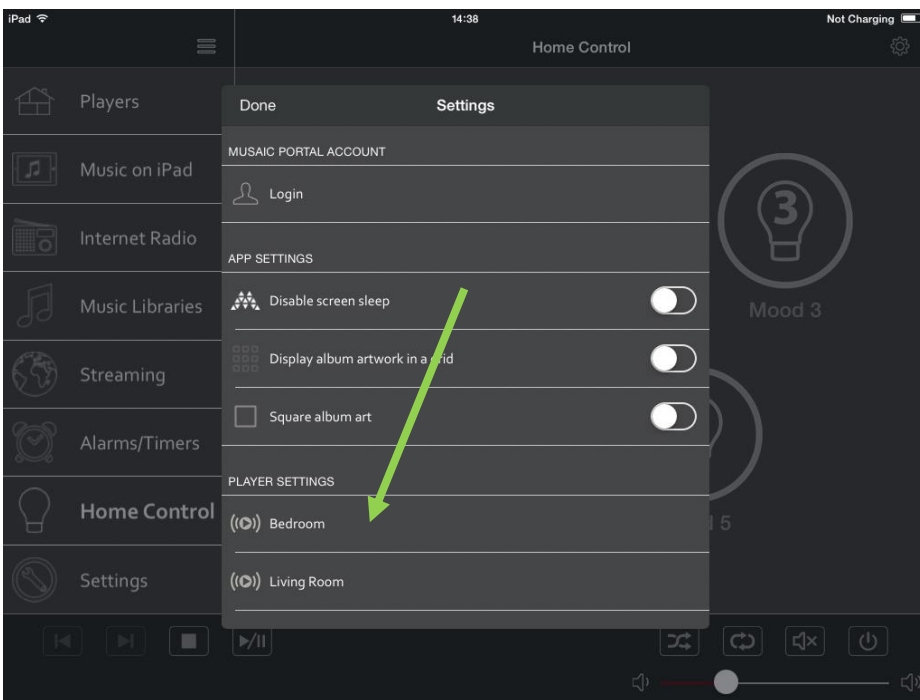

Now scroll to the bottom of the Player Settings menu and you will see an item called Link Player to account.

Press this button to link this Player to your MUSAIC web account.

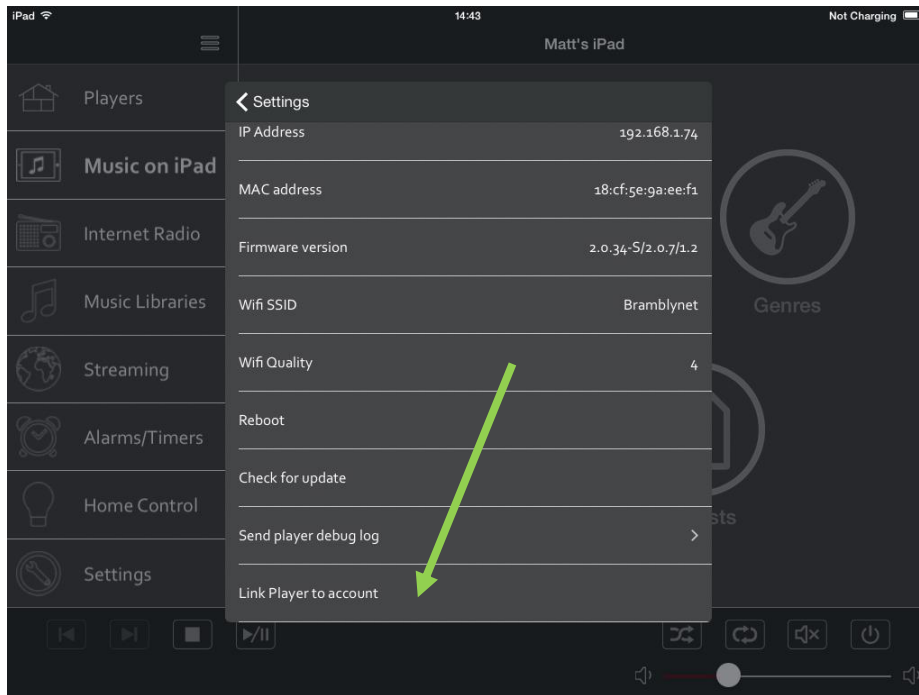

If you have more than one Player link each one to your account in turn.

THIS LAST STAGE IS VERY IMPORTANT OR YOUR MUSAIC PLAYERS WILL NOT SHOW UP IN IFTTT WHEN YOU TRY TO CREATE IFTTT RECIPES.

Creating an IFTTT account

Once you have a MUSAIC account go to the IFTTT website and sign up for an IFTTT account here:

<https://ifttt.com/join>

Next add the MUSAIC channel by clicking on Channels and entering MUSAIC into the search channels box.

You can also click Channels and scroll down to browse through all the available channels and find other things that you can connect to IFTTT. A "Channel" in IFTTT is a product or web service that can be connected and

made part of IFTTT recipes. Some channels are physical products (like Mosaic) and some (like the Date and Time channel or Weather channel) are purely web based and require no special hardware.

Browse through and connect some channels for items you have or deem useful then either experiment making some recipes or browse the many example recipes which can be added and edited.

Mosaic's own set of example recipes can be found here: <https://ifttt.com/Mosaic>

Or search Mosaic in the top search box on the IFTTT site.

You can also download the IFTTT App for iOS or Android from the Apple App store or Google Play store and create and amend recipes from your phone or tablet.

Notes on IFTTT

IFTTT is a 'near' real time system. Because IFTTT uses a cloud to cloud connection it takes a little time for each product to tell the other that it's status has changed. This makes IFTTT perfect for 'non real-time' or 'near real-time' events like 'wake me up to the radio' or 'turn off the lights when the sleep timer finishes'. With this type of event the exact time of action or the speed of action does not matter to the second.

You can of course also use IFTTT to add a Belkin WeMo light to a Home Control scene on Mosaic and other such events. Here though you must be aware that IFTTT takes a few seconds to work. Of course that's why Mosaic also supports real-time automation of Lightwave RF and Philips Hue (with more to come) as per our other guides.

There are use-cases for both methods but for many things IFTTT provides a very simple and free solution; this is the power of IFTTT.

USEFUL LINKS

IFTTT page on Mosaic website: www.mosaic.com/ifttt

Mosaic IFTTT Channel: www.ifttt.com/mosaic